

# HL555N.0

D BADEWANNEN AB- UND ÜBERLAUFGARNITUR MIT KUGELGELENK SIFON  
 GB LUXURY BATH TRAP ASSEMBLY  
 I COLONNA VASCA AUTOMATCA  
 CZ ODPADNÍ SOUPRAVA PRO KOUPACÍ VANY  
 SK ODPADOVÁ SÚPRAVA PRE KÚPACIE VANE

## ZUBEHÖR / ACCESSORIES / ACCESSORI PØISLUŠENSTVÍ/PØISLUŠENSTVO

HL555N.1 HL555N.3  
 HL555N.2 HL555N.4

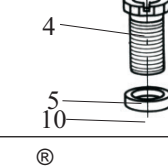
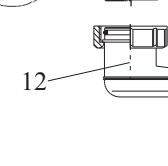
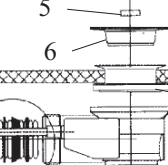
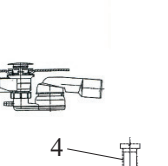
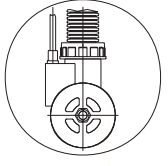
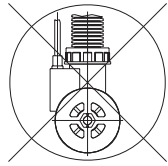

**1- Überlaufgehäuse**  
 Case / Scatola  
 Pøepad /Prepad

**2- Ventil Dichtung 01011D**  
 Grey washe/ Guarnizione piana  
 Tøsnøni ventilu  
 Tesnenie ventilu

**3- Flansch**  
 Flange / Flangia  
 Pøitlaønny taløf/  
 Pøitlaønny tanier

**4- Ventilschraube**  
 Waste screw  
 Vite piletta  
 Šroub ventilu  
 Skrutka ventilu

**5- Distanzring**  
 Thickness/ Spessore  
 Distanønny(kø) køružek(køružok)

**6- Ventilteller**  
 Waste/Piletta  
 Taløfek ventilu/Tanier ventilu

**7- Ventil Dichtung 01070D**  
 Grey washe/ Guarnizione piana  
 Tøsnøni ventilu  
 Tesnenie ventilu

**8- O-Ring**  
 O-Køružek/O-Køružok

**9- Keildichtung**  
 Conical washer  
 Guarnizione conica  
 Klinovø tøsnøni  
 Klinovø tesnenie

**10- Stützring**  
 Washer  
 Rondella  
 Tøsnøni  
 Tesnenie

**11- Holländermutter**  
 Compression Nut  
 Calotta  
 Pøevleønna matice  
 Pøevl.matice

**12- Sifon 0555.5E**  
 Bath trap, Sifone  
 Zápachovø uzãvørka  
 Zápachovø uzãver

**13- Ring**  
 Køružek/Køružok

D Bei Gußwannen Distanzring abnehmen (entfernen).  
 I Per le vasche in ghisa togliere lo spessore.  
 GB For basin in cast iron pick up the thickness  
 CZ U litinovøch vanvanø vyjmout distanønny køružek  
 SK U liatinovøch vyňatø distanønny køružok

10/13

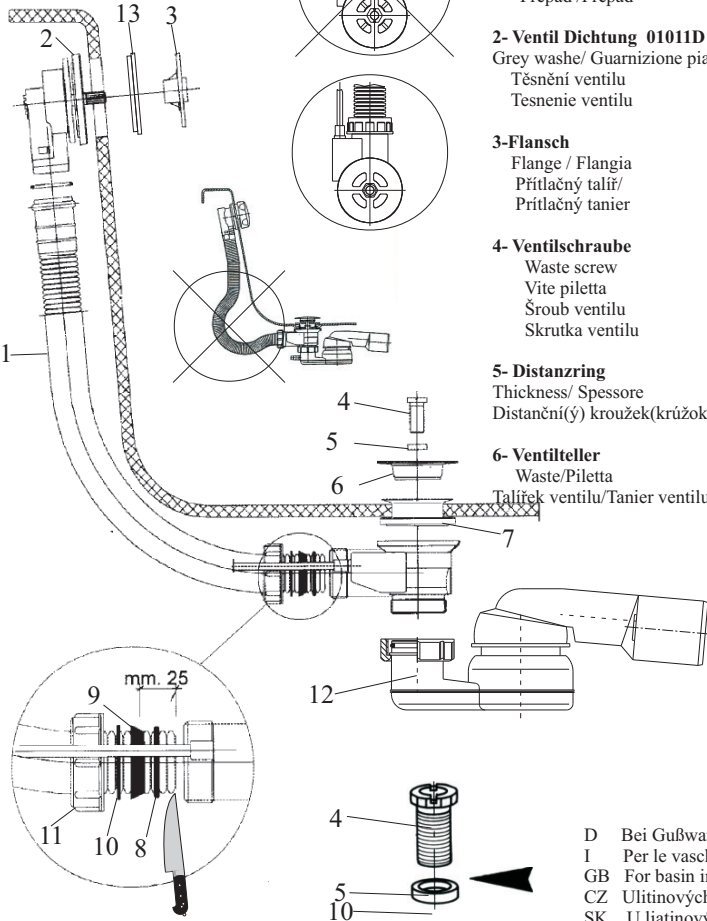

# HL555N.0

D BADEWANNEN AB- UND ÜBERLAUFGARNITUR MIT KUGELGELENK SIFON  
 GB LUXURY BATH TRAP ASSEMBLY  
 I COLONNA VASCA AUTOMATCA  
 CZ ODPADNÍ SOUPRAVA PRO KOUPACÍ VANY  
 SK ODPADOVÁ SÚPRAVA PRE KÚPACIE VANE

## ZUBEHÖR / ACCESSORIES / ACCESSORI PØISLUŠENSTVÍ/PØISLUŠENSTVO

HL555N.1 HL555N.3  
 HL555N.2 HL555N.4

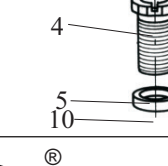
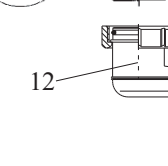
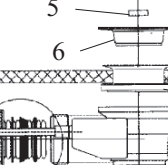
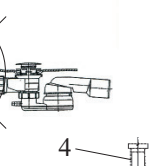
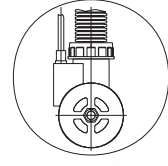
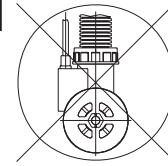

**1- Überlaufgehäuse**  
 Case / Scatola  
 Pøepad /Prepad

**2- Ventil Dichtung 01011D**  
 Grey washe/ Guarnizione piana  
 Tøsnøni ventilu  
 Tesnenie ventilu

**3- Flansch**  
 Flange / Flangia  
 Pøitlaønny taløf/  
 Pøitlaønny tanier

**4- Ventilschraube**  
 Waste screw  
 Vite piletta  
 Šroub ventilu  
 Skrutka ventilu

**5- Distanzring**  
 Thickness/ Spessore  
 Distanønny(kø) køružek(køružok)

**6- Ventilteller**  
 Waste/Piletta  
 Taløfek ventilu/Tanier ventilu

**7- Ventil Dichtung 01070D**  
 Grey washe/ Guarnizione piana  
 Tøsnøni ventilu  
 Tesnenie ventilu

**8- O-Ring**  
 O-Køružek/O-Køružok

**9- Keildichtung**  
 Conical washer  
 Guarnizione conica  
 Klinovø tøsnøni  
 Klinovø tesnenie

**10- Stützring**  
 Washer  
 Rondella  
 Tøsnøni  
 Tesnenie

**11- Holländermutter**  
 Compression Nut  
 Calotta  
 Pøevleønna matice  
 Pøevl.matice

**12- Sifon 0555.5E**  
 Bath trap, Sifone  
 Zápachovø uzãvørka  
 Zápachovø uzãver

**13- Ring**  
 Køružek/Køružok

D Bei Gußwannen Distanzring abnehmen (entfernen).  
 I Per le vasche in ghisa togliere lo spessore.  
 GB For basin in cast iron pick up the thickness  
 CZ U litinovøch vanvanø vyjmout distanønny køružek  
 SK U liatinovøch vyňatø distanønny køružok

10/13

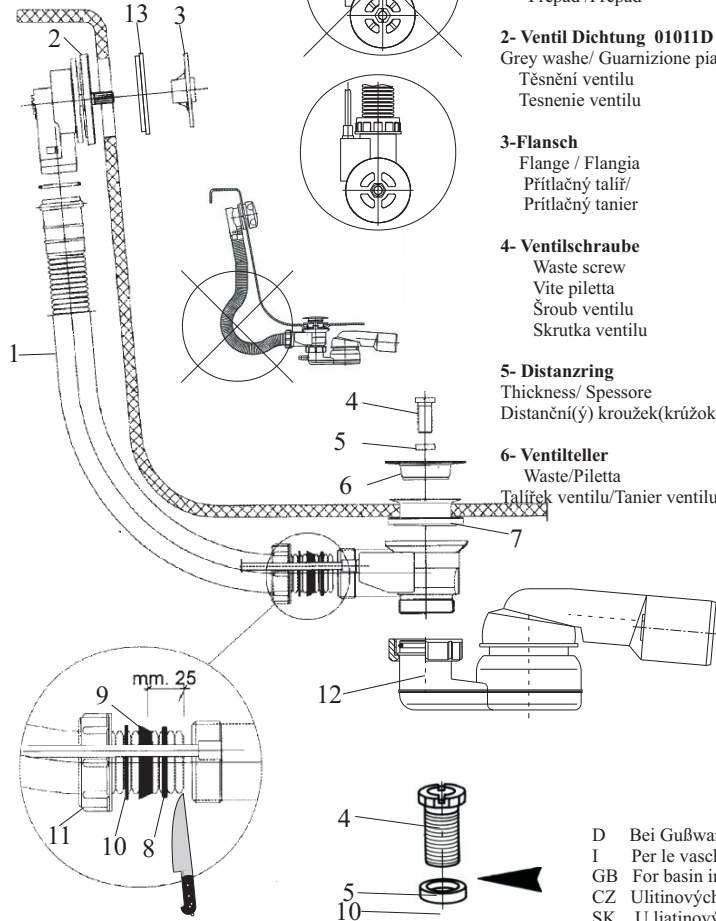

SIFONE HL ABLÄUFE  
 HL HUTTERER + LECHNER GmbH A-2325 HIMBERG, BRAUHAUSGASSE 3-5  
 Telefon: 0043 / (0)2235 / 86 291-0  
 Tel. Fax: 0043 / (0)2235 / 86 291- 31 od. 52  
 http:// www.hutterer-lechner.co.at

SIFONE HL ABLÄUFE  
 HL HUTTERER + LECHNER GmbH A-2325 HIMBERG, BRAUHAUSGASSE 3-5  
 Telefon: 0043 / (0)2235 / 86 291-0  
 Tel. Fax: 0043 / (0)2235 / 86 291- 31 od. 52  
 http:// www.hutterer-lechner.co.at